



# Migali®

## COMPETITOR SERIES®

PROJECT: \_\_\_\_\_

LOCATION: \_\_\_\_\_

ITEM#: \_\_\_\_\_

QUANTITY: \_\_\_\_\_



C-U27F-HC



C-U48F-HC



C-U60F-HC

# UNDER-COUNTER/WORK TOP FREEZERS

- Beautiful ergonomic construction & rounded corners
- Digital Controller with Temperature Read-out
- All stainless steel exterior and interior
- Forced air refrigeration system
- Recessed door handles
- Pre-installed casters and shelving
- 90 degree hold open door feature for loading products
- Optional Accessory: Backsplash for Work-Tops for in-the-field installment
- All Natural R290 Hydrocarbon Refrigerant
- US Department of Energy Certified
- Migali® Protection Plan: 1 Year Parts & Labor Warranty, 5 Years Compressor Warranty

MODEL	DOORS	CAPACITY CU/FT	SHELVES	H/P	AMPS	VOLTAGE	ENERGY CONSUMPTION KWH/24 HR	PLUG TYPE	TEMP RANGE	EXTERIOR DIMENSIONS W X D X H*	INSIDE DIMENSIONS W X D X H	PACKAGED DIMENSIONS W X D X H	WEIGHT	PACKAGED WEIGHT
C-U27F-HC	1	6.5	1	1/4	4.4	115/60/1	2.7	Nema 5-15P	-7° F (~) 3° F	27.5" x 30" x 37.25"	23.9" x 23.6" x 26.7"	29" x 32" x 39"	159 lbs.	174 lbs.
C-U48F-HC	2	12	2	1/3	6.5	115/60/1	3.9	Nema 5-15P	-7° F (~) 3° F	48.2" x 30" x 37.25"	44.7" x 23.6" x 26.7"	50" x 32" x 39"	233 lbs.	242 lbs.
C-U60F-HC	2	18.2	2	1/2	6.5	115/60/1	4.6	Nema 5-15P	-7° F (~) 3° F	60.2" x 30" x 37.25"	56.7" x 23.6" x 26.7"	63" x 32" x 39"	264 lbs.	277 lbs.

\* Total height includes casters

Accessories: Stainless Steel Back Splash - BS27 - 27" wide / BS48 - 48" wide / BS60 - 60" wide / BS72 - 72" wide

NOTE: MIGALI® RESERVES THE RIGHT TO CHANGE SPECIFICATIONS WITHOUT NOTICE



TOLL FREE: 800.852.5292  
WEB: www.migali.com



# DIMENSIONAL DRAWINGS

C-U27F-HC

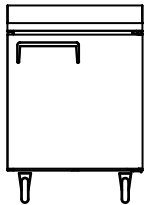

C-U48F-HC

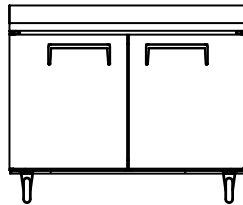

C-U60F-HC

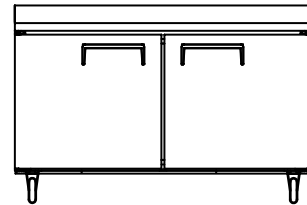

C-U27F-HC  
TOP VIEW

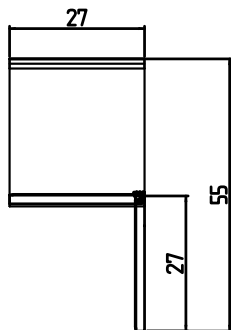

C-U48F-HC  
TOP VIEW

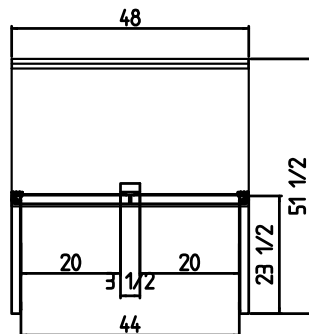

C-U60F-HC  
TOP VIEW

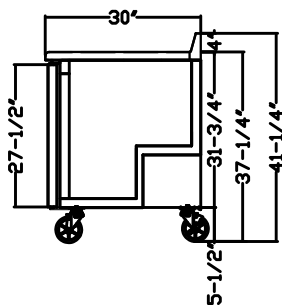
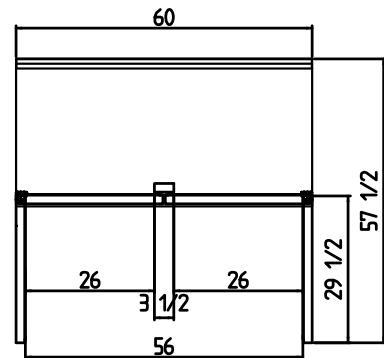

SIDE VIEW (1,2,3) DOOR MODELS



MIGALI® REMAINS AN AMERICAN FAMILY COMPANY SINCE 1955